

# Acessórios para Leitos

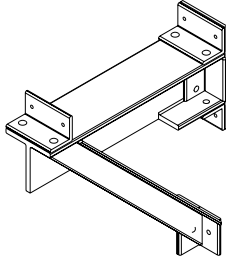

## Mão Francesa

REF.:MFE-041



## Suporte Engastado

REF.:SEE-042

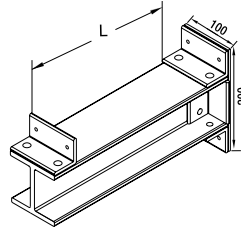

## Suporte Pedestal

REF.:SPE-036

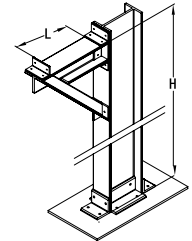

Obs.: Todos os furos com Ø11mm

## Suporte Pendural

REF.:SPE-043

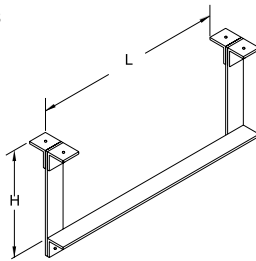

## Gotejador

REF.:DL-044

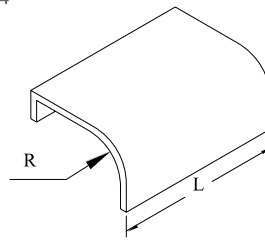

## Grapa

REF.:DL-048 (NYLON)

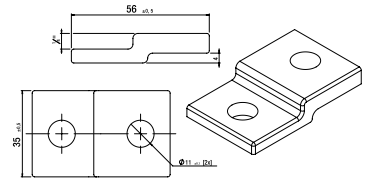

## Septo Divisor

REF.: DLE / DLL / DLP (061) - Leito  
REF.: DEL (061) - Eletrocalha

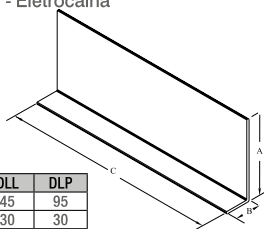

MED.	DLE	DLL	DLP
A	65	45	95
B	30	30	30

## Terminal de Fechamento

REF.:DL-037

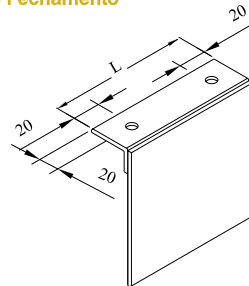

## Junção Reta

REF.:DLE / DLL / DLP (049)

Obs.: Todos os furos com Ø11mm

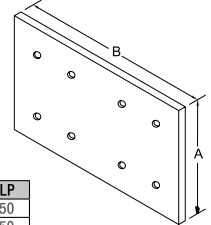

MED.	DLE	DLL	DLP
A	75	100	150
B	160	160	250

## Junção Vertical 45°

REF.:DLE / DLL / DLP (050)

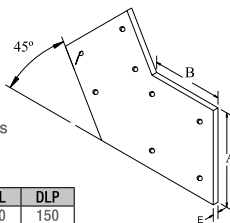

Obs.: Todos os furos com Ø11mm

MED.	DLE	DLL	DLP
A	75	100	150
B	80	107	130

## Junção Vertical 90°

REF.:DLE / DLL / DLP (051)

Obs.: Todos os furos com Ø11mm

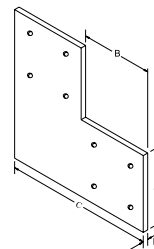

MED.	DLE	DLL	DLP
A	75	100	150
B	80	80	140
C	155	180	290

## Junção Articulada Vertical

REF.:DLE / DLL / DLP (052)

Obs.: Todos os furos com Ø11mm

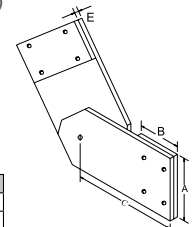

MED.	DLE	DLL	DLP
A	75	100	150
B	80	80	150
C	135	135	255

## Junção Articulada Horizontal

REF.:DLE / DLL / DLP (053)

Obs.: Todos os furos com Ø11mm

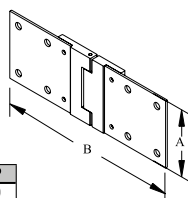

MED.	DLE	DLL	DLP
A	75	100	150
B	268	268	352

## Saída Vertical

REF.:SVE-045

Tabela para Saídas Verticais			
Nomina l	Ø	A	B
1/2"	22		
3/4"	27		
1"	35	100	100
1.1/4"	44		
1.1/2"	51		
2"	64		
2.1/2"	76		
3"	89	150	160
3.1/2"	102		
4"	121		
5"	142	200	210
6"	170		

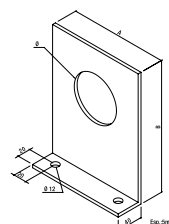

## Saída Horizontal

REF.:SHE-046

Tabela para Saídas Horizontais			
Nominal	Ø	A	B
1/2"	22		
3/4"	27		
1"	35	100	140
1.1/4"	44		
1.1/2"	51		
2"	64		
2.1/2"	76		
3"	89	150	200
3.1/2"	102		
4"	121		
5"	142	200	250
6"	170		

